

PARTS LIST

PROTO 2000  
HOF7A LOCOMOTIVE  
with Sound & DCC  
PARTSLIST

PART#	KEY #	DESCRIPTION
922-581563	1A	F7A Body shell with dynamic brakes, without steam generator & all detail parts shown with body shell *
922-581564	1B	F7A Body shell with dynamic brakes, with steam generator & all detail parts shown with body shell *
922-581566	1C	F7A Body shell without dynamic brakes, with steam generator & all detail parts shown with body shell *
922-581571	1D	F7A Body shell without dynamic brakes, without steam generator & all detail parts shown with body shell *
N/A	*	All windows & lenses, pilots, handrails, grabirons & ladder stand-offs, horns, antennas, etched grilles, and other exterior and cab interior parts (enough parts to fully detail the body)
922-581610	2	F7A frame, A-frame & screws (sound version)
922-581599	3B	F7A/B Large & small PCB with wires and screws
922-581600	4C	F7A LEDs & holder and screws (for w/o mars light) (sound version)
922-581601	4D	F7A PCB w/LEDs, holder & screws (for w/mars light) (sound version)
922-581576	5	F7A/B Universal joints & worm cover (1 set - enough for one loco)
922-581579	6B	F7A/B Motor with single flywheel, motor mounts & screws and universal sockets (for version with sound)
922-581580	7	F7A/B Fuel tanks (2), hanger brackets, pipes and screws
922-581581	8A	Couplers, complete (1 short shank & 1 standard shank)
922-581583	9	Blomberg truck with gears, worm cover, sideframes and all sideframe details (1 - assembled)
922-581584	10	Blomberg sideframe set and all sideframe details (4 sets - enough for 2 trucks)
922-581585	11	Geared wheelset (40 scale inch wheels, helical gear, bearings) (4)
922-581602	12	F7A/B Twin speakers with wires and screws

**TO ORDER REPLACEMENT PARTS:**  
 1. Identify parts in drawings on exploded views of chassis and body pages.  
 2. Locate part number above.  
 3. Contact Walthers at 1-800-487-2467 to place your order.

F7 A-Unit  
Locomotive  
(with Sound & DCC)



CONGRATULATIONS!

You have just purchased one of a series of the finest running, most detailed model locomotives available today. It is equipped with a diecast chassis and a totally redesigned state of the art drive system that is second to none. Your new **PROTO 2000** HO Scale **F7A** diesel locomotive has been carefully hand-assembled and tested before leaving our modern factory. Additionally, it has been engineered to provide virtually trouble-free service and operation.

REMOVAL INSTRUCTIONS

- Carefully remove the locomotive from its protective foam packaging.
- Remove the end protectors by unscrewing the phillips head screws on the bottom of the chassis at each end.
- Using the screws you just removed, align the couplers and coupler boxes as shown in the exploded view and tighten the screws to the chassis
- **Important:** Retain this package and all packing materials in case you need to ship locomotive for servicing.

**Break-In.** To break-in your F7A, operate it at varying speeds, starting and stopping it frequently while running it in both forward and reverse for an hour or so. This will allow the motor brushes to “seat” and adjust to ensure improved operation for the life of your locomotive.

**LUBRICATION AND CLEANING**

**Frequency**

As with any precision mechanical equipment, occasional lubrication and maintenance is required for optimum performance. PROTO 2000 locomotives, with their precision-engineered reduction gears, motor and chassis need only occasional, careful lubrication and cleaning.

- Models used infrequently or not at all should not be lubricated more often than once a year. Excessive amounts of lubricant can migrate to the driver tires and cause reduced tractive force and grime on rail heads.
- Models which are run often and pull long consists on grades should be inspected and lubricated every two or three months.

**Instructions**

**Bearing Areas.** A small patch of cloth held with tweezers should be used to clean bearing areas before lubrication. With the model upside down, place a drop of light oil at each wheel bearing. *Do not over lubricate.*

**Worm Gears.** By extracting the body shell and metal chassis weights the snap-on covers over the drive worms can be removed. Light grease should be applied to the worm gear with a toothpick.

**Idler Gears.** A drop or two of light oil can also be applied to the plastic idler gears below the worm gear. As they are made from slippery plastic, the gears require little maintenance.

**DYNAMIC BRAKE SOUND**

Your A-unit comes with all sounds activated, including the dynamic brake sound. We have provided this as a choice for modelers who like the sound of dynamic brake operation, even if their model does not come equipped with that feature.

You may choose to reduce the volume or to mute (turn off) this sound if the prototype for your model does not have dynamic brakes. Check the Operations manual for instructions.

MAINTENANCE

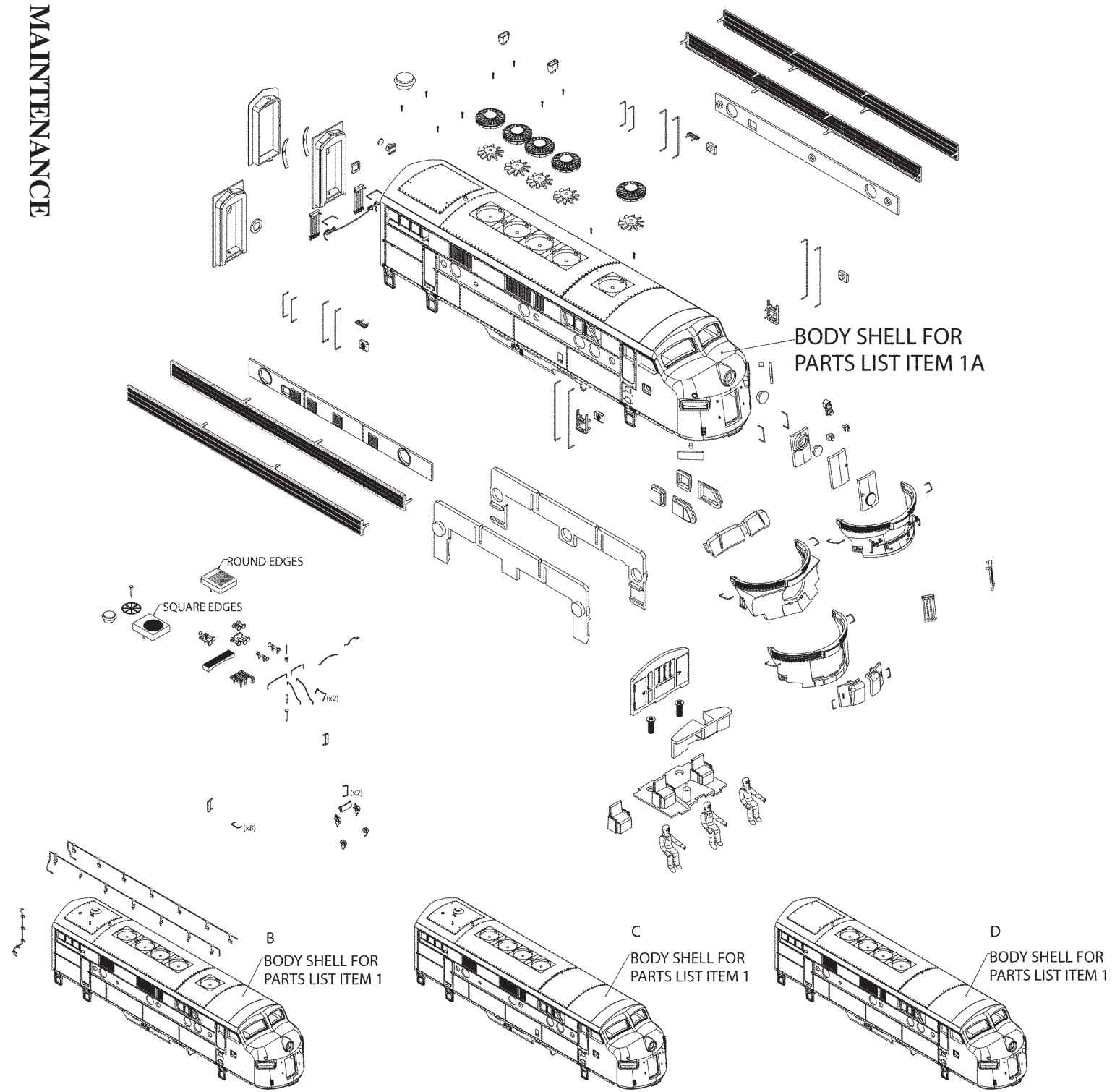

EXPLODED VIEW OF BODY

FOR WARRANTY INFORMATION AND ASSISTANCE CALL TOLL-FREE: 1-800-773-9350

**WALTHERS**



© 2008 Wm. K. Walther, Inc.  
5601 W. Florist Ave. • Milwaukee, Wisconsin 53218  
www.walthers.com